

Amerec K2 Steamer Control and SaunaLogic App For use with AK Steam Generators

FOR THE SAFETY OF YOU AND YOUR FAMILY PLEASE READ THE WARNINGS TO THE RIGHT AND ALL INSTRUCTIONS BEFORE USING YOUR STEAMBATH.

POST "WARNING" LABEL OUTSIDE STEAM BATH FOR SAFETY WARNINGS. POSTING IS REQUIRED ON OR ADJACENT TO STEAM ROOM DOOR FOR ALL COMMERCIAL INSTALLATIONS.

SAVE THIS MANUAL

Thank you for purchasing your new Amerec steam generator. If we can be of any assistance do not hesitate to call our Technical Support at 1-800-363-0251.

The K2 control is to be used only with a compatible AK steamer from Amerec. If you have an older AK, contact Tech support for information about upgrading to a compatible version.

The K2 does not come with a built in temperature sensor so a wall mounted sensor must be installed in the steam bath.

The K2 may be installed on the wall either inside or outside the steam room. *Only one K2 may be installed.* If a second control is desired, you may add an optional K4 On/Off control or a K3 (with temperature and time adjustments). The K3 and K4 may be installed inside or outside the room.

The K2 comes with a Wi-Fi module which allows using an app in addition to the K2. The SaunaLogic app is free for android or iOS devices and communicates with Alexa, Echo and Siri devices. The Wi-Fi module connects to the steamer with a 25 ft (7,6 m) cable (provided) to allow positioning the module where it will have the best communications with your Wi-Fi system.

WARNING

The K2 control operates on 5VDC and does not present a shock hazard. **Electric Shock Hazard** - High voltage exists within the steam equipment. There are no user serviceable parts in this equipment. All installation and service to this equipment should be performed by qualified licensed personnel.

Do not exceed 30 minutes in a steam bath. Excessive exposure can be harmful to your health. Excessive exposure can produce a rapid pulse, light-headedness, weakness or fainting. If you become uncomfortable or experience any of the above conditions exit the steam bath immediately.

Steam baths can put stress on the body. Therefore a steam bath should be used only under a doctor's direction if you:

- Are pregnant
- Have diabetes
- Have a heart condition
- Have high blood pressure
- Have circulatory problems
- Are under the influence of alcohol
- Are under the influence of drugs
- Are under the care of a physician
- Are in generally poor health

Children should only use the steam bath under close adult supervision.

Scald Hazard: Do Not Touch the steam head or trim during operation as they are HOT. Stay at least 12 inches away from the hot steam escaping from the steam head.

Be careful when entering a steam bath. Escaping steam from an overheated steam room may cause injury.

⚠ WARNING

REDUCE THE RISK OF OVERHEATING AND SCALDING

1. Exit immediately if uncomfortable, dizzy or sleepily. Staying too long in a heated area is capable of causing overheating.
2. Supervise children at all times.
3. Check with a doctor before use if pregnant, diabetic, in poor health or under medical care.
4. Breathing heated air in conjunction with consumption of alcohol, drugs or medication is capable of causing unconsciousness.

CAUTION! Do not contact steam head. Stay at least 12" away from hot steam escaping from the steam outlet.

REDUCE THE RISK OF SLIPPING AND FALL INJURY

Use care when entering or exiting the steam room, floor may be slippery.

NOTE: For additional safety instructions, see owner's manual.



IMPORTANT SAFETY INSTRUCTIONS

1. READ AND FOLLOW ALL INSTRUCTIONS.
2. WARNING - To reduce the risk of injury, do not permit children to use this product unless they are closely supervised at all times.
3. WARNING - To reduce the risk of injury:
 - a. The wet surfaces of steam enclosures may be slippery. Use care when entering or leaving.
 - b. The steam head is hot. Do not touch the steam head and avoid the steam near the steam head.
 - c. Prolonged use of the steam system can raise excessively the internal human body temperature and impair the body's ability to regulate its internal temperature (hyperthermia). Limit your use of steam to 10 - 15 minutes until you are certain of your body's reaction.
 - d. Excessive temperatures have a high potential for causing fetal damage during the early months of pregnancy. Pregnant or possibly pregnant women should consult a physician regarding correct exposure.
 - e. Obese persons and persons with a history of heart disease, low or high blood pressure, circulatory system problems, or diabetes should consult a physician before using a steam bath.
 - f. Persons using medication should consult a physician before using a steam bath since some medication may induce drowsiness while other medications may affect heart rate, blood pressure and circulation.
4. WARNING - Hyperthermia occurs when the internal temperature of the body reaches a level several degrees above the normal body temperature of 98.6°F. The symptoms of hyperthermia include an increase in the internal temperature of the body, dizziness, lethargy, drowsiness and fainting. The effect of hyperthermia include:
 - a. Failure to perceive heat:
 - b. Failure to recognize the need to exit the steam bath:
 - c. Unawareness of impending risk:
 - d. Fetal damage in pregnant women:
 - e. Physical inability to exit the steam bath: and
 - f. Unconsciousness.

WARNING - The use of alcohol, drugs or medication can greatly increase the risk of hyperthermia.

SAVE THESE INSTRUCTIONS

K2 CONTROL OVERVIEW

The K2 control is a low voltage wired control for use with Amerec's AK series steam generators. The control requires an 8 conductor CAT-5 cable (provided) to connect to the steamer. A temperature sensor (required) mounts inside the steam room and connects to the steam generator.

The K2 uses touch screen switches to control the bath and options:

- start and stop the steam bath
- set or display the bath temperature *
- set the bath run time **
- set a delayed start time for the steam bath
- control low voltage room lights (*optional*)
- control a 2nd option, such as Amerec's bluetooth connected speaker system (*optional*)

*The bath temperature may be displayed in either °F or °C, selected using a jumper on the steamer's circuit board.

** The bath time may be set for up to 60 minutes (default). A jumper on the steamer's circuit board may be used to set for a maximum bath time of up to 24 hours.

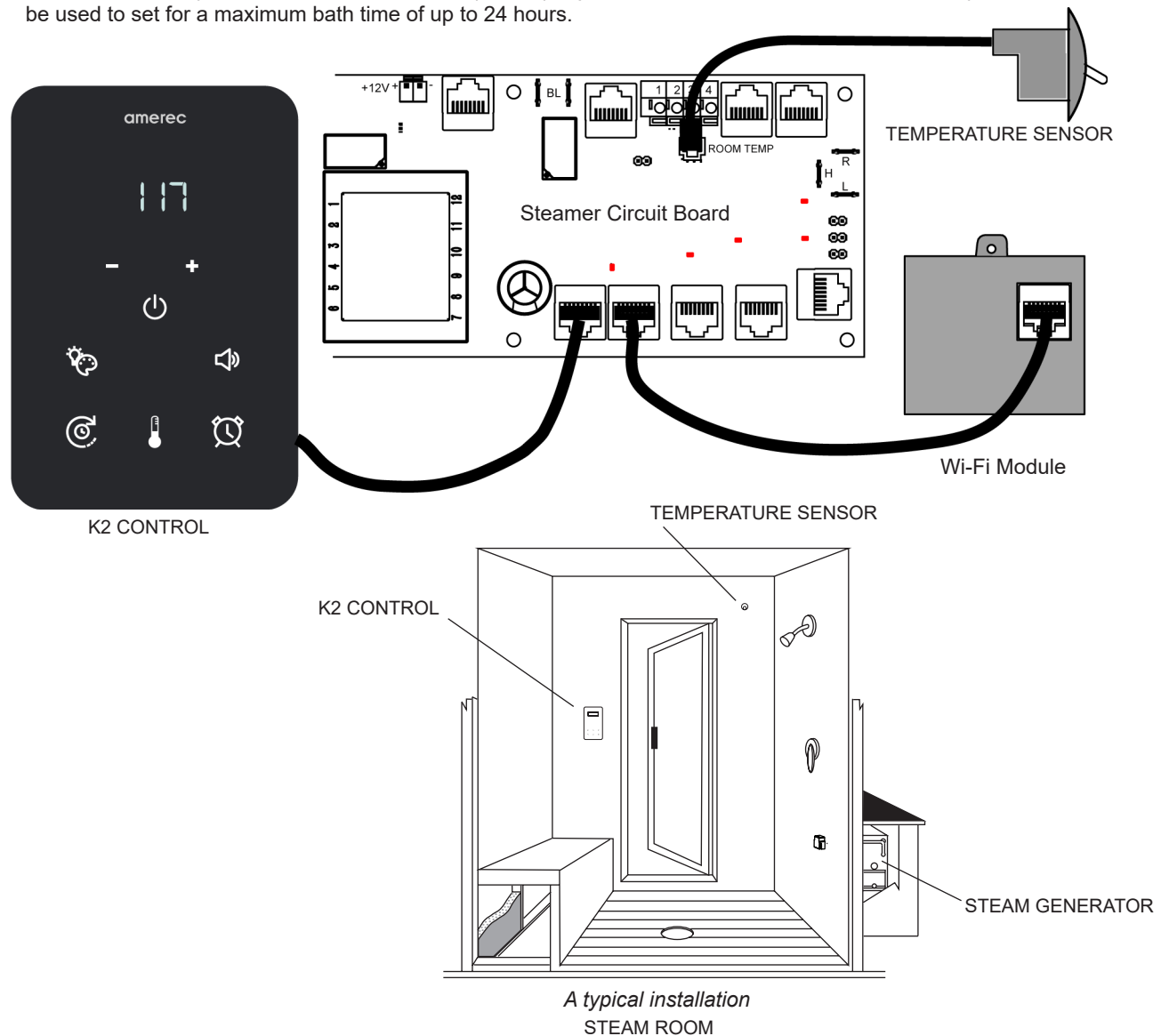

K2 OPERATION

*Display shows current bath temperature
and bath time remaining while bath is on.*



K2 Control

Display When power to the steamer is turned on, the K2 will set-up its program and display the software version (such as S011) for about 5 seconds then the display will turn off. While the bath is on, the display alternates between showing the current bath temperature and the time remaining before the bath automatically turns off.

— Tap to decrease setting

+ Tap to increase setting



On/Off Tap to start and stop the steam bath



LED light control Amerec Spectra LED lights may be turned on or off at any time and must be turned on/off manually. *This control is dedicated to special amerec Spectra LED lights and must not be used with other lights.*

The amerec LEDs provide white lighting or various colors

- Tap the icon to turn the lights on. To turn the lights off, tap and hold the icon 3 seconds or step through to the end of the color selection.
- The lights will always start at white when first turned on.
- Tap the icon to change the display colors.

Color sequence: White – Red – Green – Blue – Yellow – Aqua – Purple – Rotating colors – Off

The amerec LEDs are dimmable

- Turn the lights on then press the + or – minus icons to adjust the brightness. The current brightness level is displayed for 3 seconds.
- The brightness can be adjusted to 25%, 50%, 75% or 100% light output.



Option On/Off control Tap the icon to turn on or off an optional device at any time. The device must be turned on/off manually. *This option does not turn off automatically after a bath.*

- This control provides an on/off switch control for low voltage, low current devices. It could be used to turn amerec's bluetooth speakers on/off, control amerec's standard LED lighting, etc.
- Loads should be limited to about 2A and 30V or less.



Set Bath Run Time With the bath on, tap the icon then use the + and - icons to increase or decrease the bath run time. *Note: you must use a jumper on the steamer circuit board to choose between a max time of 60 minutes or 24 hours.*

- In 60 minute mode (*this is the default setting*):
30 minutes default
settable 5 to 60 minutes
set in 5 min steps
- 24 hr mode (*Note: in 24 hour mode the display shows remaining time in hours and minutes but without a :*)
1 hour default
settable 1 to 24 hours
set in 1 hour steps



Set the Bath Temperature Turn the bath on then tap the temperature icon and use + and - icons to raise or lower the bath's temperature. *Note: you must use a jumper on the steamer circuit board to choose between a display in °F (default) or °C.*

- Bath temperature is 120°F (49°C) default.
- settable 84°F (29°C) to 125°F (52 °C)
- Set in 1° steps.



Set delayed start A bath can be set to begin at a later time, such as setting it before going to sleep so it is ready to use when you get up in the morning. *See the General section for more details.*

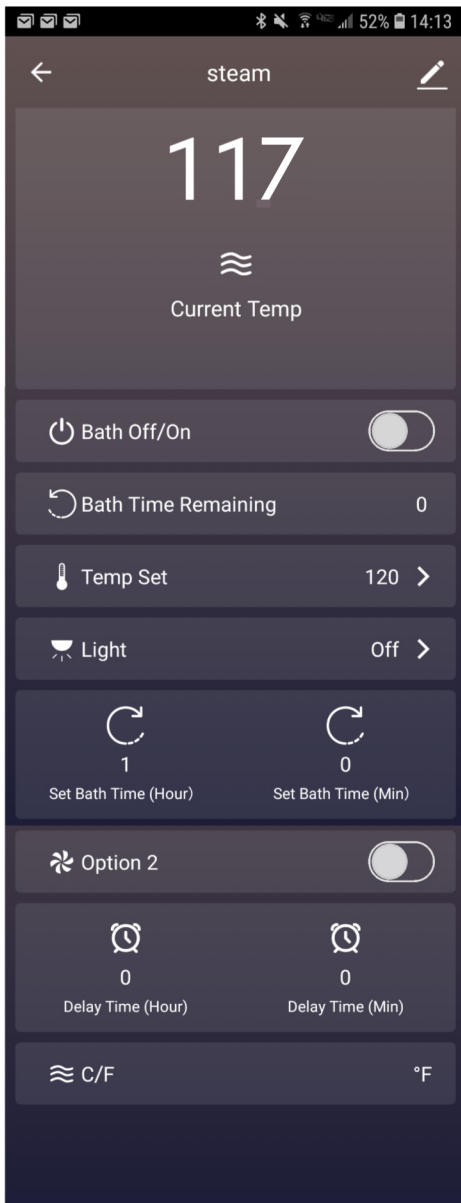

- With bath on, press icon then use + & - icons to raise or lower delay setting. The delay time is adjustable from 15 minutes to 24 hours in 15 minute steps. Default is 1 hour.
- After setting the delay time, wait about 3 seconds the bath will turn off and the control will alternately display **dIAy** and the delay time remaining. *Note that the K2's on/off icon will remain lit while the delay is counting down.*
- After delay has run out, the bath will run with previously set bath time & temperature.
- Press the icon again to cancel the delay.

K2 Saunalogic Steam App



NOTE: The complete App display is shown above. The operations shown on your phone or tablet will depend on your screen size. If your display does not show the complete view above, use your finger to scroll the display up to show more of the list.

Display The Display area shows the current room temperature in the Steam Bath

Bath Off/On Move the slider button  to the right by sliding the round button or tapping the open area next to the button. The slider will change to green  while the bath is on. To turn the bath off, move the slider to the left.

Bath Time Remaining shows how long the bath will run before automatically turning off (in minutes). See below for setting the bath time.

Temp Set The bath temperature setting is shown at the right side of this menu bar. To change the setting, tap > and the Temp setting screen will appear. The current setting will appear with - and + signs along side the temperature. Tap the - to lower the setting and + to increase it. When done, tap **OK**.

Light The light option controls our Spectra LED lights. These lights provide white or color lighting. Tap the > and the light setting screen will appear. Select the color you want to use or to turn the lights off, then tap **OK**.

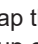
Set Time To set how long the steam bath will run before automatically turning off, tap the  for hours or minutes and a setting screen will appear. Scroll up or down to the run time you want, then tap **OK**. Note that the hours and minutes are set separately: The default maximum time is 60 minutes and suitable for most use. *Note: you must use a jumper on the steamer circuit board to choose between a max time of 60 minutes (default) or 24 hours. Contact Amerec Technical Support for assistance with this change.*

Option 2 If you choose a low voltage option which is controllable by an on/off switch, you can control it with this option. Connect the control line to a relay on the steamer's circuit board then run the switched output from the board to the option. Use the same actions as for the bath Off/On switch to turn this option's switch on and off. *Contact Amerec Technical Support for assistance with this.*

Set Delay Time You may set the bath to turn itself on after a delay, such as when you want the bath ready to use when you get up in the morning. Turn the bath on then tap the hours or minutes icons as you did in Set Bath Time and adjust the length of delay you want. When finished, the bath will turn off and the displays on the K2 and the App will alternately show delay and the time remaining before the bath starts. *Note: the delay time will be shown in minutes.*

C/F This bar show the temperature scale used for the displayed bath temperature. You cannot change this through the App. To select °C or °F (default setting), you must use a jumper on the steamer circuit board to change the setting.

General Information

The displays on the K2 and App show more than just the temperature (and remaining bath time on the K2)

K2 Program When power is turned on to the steam generator, The K2 will start up, then show its software version for 5 seconds. This can be good information to have when contacting Technical Support with operating issues.

Temperature Sensing There are three error codes associated with the temperature sensing operations:

EE01 | This indicates a missing or damaged steam room temperature sensor. It could be a missing or malfunctioning sensor, a bad cable, or other problems. If the problem is corrected, simply turn the bath off and back on again and the temperature displays should be fine again. *If you have issues, please contact Technical Support.*

EE02 | This indicates a shorted steam room temperature sensor. It could be a malfunctioning sensor, corroded connectors, a damaged cable (such as a staple through the cable, or other problems. If the problem is corrected, simply turn the bath off and back on again and the temperature displays should be fine again. *If you have issues, please contact Technical Support.*

EE55 | This indicates a steam room temperature measured much too hot. If you see this reading, immediately turn the bath off until the problem is found and corrected. **There is a risk of being scalded if the room overheats.** Once the problem is corrected, you must turn the steamer's power off and back on again to reset the error circuit. **This is done to ensure you know there was a problem so you can have it fixed before resuming operation.** *If you have issues, please contact Technical Support.*

Defaults:

Steam Bath Temperatures may be set in 1° steps from 84°F (29°C) to 125°F (52°C). The factory setting is 120°F (49°C).

Steam Bath Run times are up to 60 minutes or up to 24 hour maximum, as set using a jumper on the steamer's circuit board..

- 60 minute mode: 30 minutes default, adjustable from 5 to 60 minutes in 5 minute steps. While setting, the display shows **M** followed by the minutes.
- 24 hour mode: 1 hour default, adjustable from 1 to 24 hours in 1 hour steps. While setting, the display shows **H** followed by the minutes.

Light Option: Spectra Lights provide white or colored light from the same LED light. The light will always start at white after power has been turned off or after the lights have been turned off.

Delay Start start times are settable for up to 24 hours and must be re-set for each session. The default delay is 1 hour. *Always make sure the steam room is ready for a bath before starting a delay: no towels in the room, door closed, and so on.*

General Information (continued)

 **Light Option** The LED lights use a special control circuit to give you good control of their appearance. **The circuits are dedicated to Amerec's Spectra LEDs and must not be used with any other LED or Light.**

- When first turned on, the lights will always start as White.
- On the K2: Turn the lights on by tapping the light icon. To turn them off again, scroll through to the end of the colors or press the icon for about 3 seconds. *Note: the lights do not turn off automatically, they must be turned off manually.*
- The K2 can change the LEDs colors (in sequence): press the icon quickly to step through *White - Red - Green - Blue - Yellow - Aqua - Purple - Rotating colors - Off.*
- The K2 may be used to dim the lights. On the K2, turn the lights on then use the + and - to adjust the brightness up or down. The light output can be adjusted to 25, 50, 75 or 100% of full brightness. *The app cannot adjust brightness.*
- On the App: Turn the lights on by tapping the Light Option's > icon then choose a color from the settings. To turn them off again, press the > then choose Off in the settings. *Note: the lights do not turn off automatically; they must be turned off manually.*
- The App can change the LEDs colors (in sequence) using the settings to step through *Off - White - Red - Green - Blue - Yellow - Aqua - Purple - Rotating colors*

 **Delayed Start** can be set to begin at a later time, such as setting it before going to sleep so it is ready to use when you get up in the morning. Start times are settable for up to 24 hours and must be re-set for each session. *Always make sure the steam room is ready for a bath before starting a delay: no towels in the room, door closed, and so on.*

- Default delay is 1 hour
- Delay times can only be set after turning the bath on. Once the delay is started,
 - the K2 will alternately show the remaining time before the bath is scheduled to start and DELAY
 - the app will continue to show that the bath is on and the delay settings will scroll down in 1 hour and in 5 minute steps
- K2 Delay time is adjustable from 15 minutes to 24 hours in 15 minute steps
- App delay time minutes are adjustable from 5 to 60 minutes in 5 minute steps and delay hours are adjustable from 1 to 24 hours in 1 hour steps

amerec

Technical Support
575 Cokato St E
Cokato, MN 55321
Phone 320-286-3500
1-800-363-0251

email: support@amerec.com